



## Body Worn Camera Miniature Body Worn Illuminated H.264 Camera System

Miniature 1080p30 IP Camera  
H.264 Streaming with  
Recording Option

Representing the forefront of IP camera technology, this camera system couples a 1080p30 high sensitivity system on chip imager with a highly integrated H.264 IP encoder. These combine to produce the smallest, lowest power HD IP camera system available.

From this core technology, Visual Engineering has created a body worn product to satisfy the needs of tactical users. Encased in CNC machined aluminium the BWC is designed to thrive in harsh operational environments.

The BWC is available with either a 90° or 60° horizontal field of view. It can also be configured to have white or covert 940nm IR LED illumination. A newly featured switch allows the user to disable the LED or have it auto switching, the control of which is dependant upon the ambient lighting conditions.

Cable egress is performed with an IP67 cable gland with strain relief. Cable termination is customer specified for differing transmission equipment.

It also features a recording option, which employs secure micro SD card storage. Access to the stored video files can be either by physically removing the SD card or via FTP transfer.

Camera configuration is supported via a web page interface.

### Overview

Miniature HD IP Camera

1920 x 1080p30 Resolution

H.264 & MJPEG Streaming

SD Card Recording Option

Sensitivity of <0.1 Lux

Pinhole Lens

White or IR LED Illumination

LED Auto/Disable Switch

Web Page Control Interface

Tactical Vest Attachment

Low Power

Small Size

CNC Machined Housing

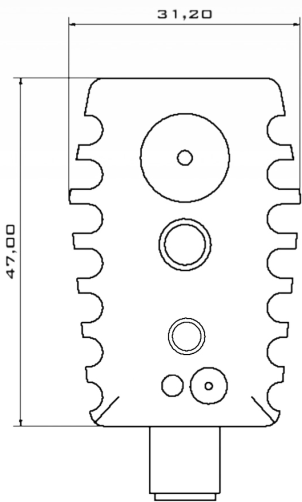

All dimensions are in mm

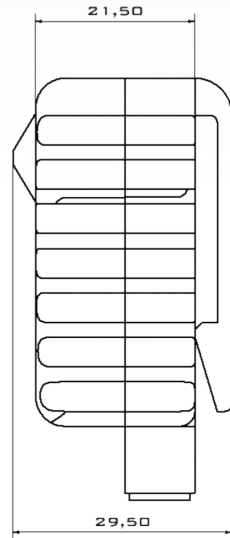

The BWC is available with either a 90° or 60° horizontal field of view. It can also be configured to have white or covert 940nm IR illumination. The part number for each variant is detailed in the table below.

Part Number	LED Option	Lens FOV (Horizontal)
110-9920	IR	90°
110-8975	White	90°
110-4046	IR	60°
110-4047	White	60°

Specifications			
<b>Camera Sensor</b>	2Megapixel, CMOS	<b>Optional Recording</b>	32GB micro SD Card
<b>Camera Sensitivity</b>	< 0.1 Lux	<b>Power Consumption</b>	2W, 2.5W Illuminated
<b>Camera Resolution</b>	Max: 1920 x 1080p30 Min: 320 x 240	<b>Streaming Protocol</b>	RTSP over TCP or UDP
<b>Video Encoding</b>	H.264 and MJPEG Dual Streaming	<b>Control Interface</b>	Web Client
<b>Max Bit Rate</b>	10Mb/s	<b>Environmental</b>	IP65
<b>Field of View</b>	Horizontal 90° or 60°	<b>Dimensions</b>	47 x 31.2 x 29.5mm
<b>LED Illumination</b>	Auto Switching or Disabled	<b>Weight</b>	60 grams

**Visual Engineering Technologies LTD**

Kemps Farm  
Stanway  
Colchester  
Essex  
CO3 8NB  
UK



**Tel:** +44 (0)1206 211842  
**Web:** [www.visualengineering.co.uk](http://www.visualengineering.co.uk)  
**Email:** [sales@visualengineering.co.uk](mailto:sales@visualengineering.co.uk)